

**TR**  
**三通变径接头**  
Tee reducer connector

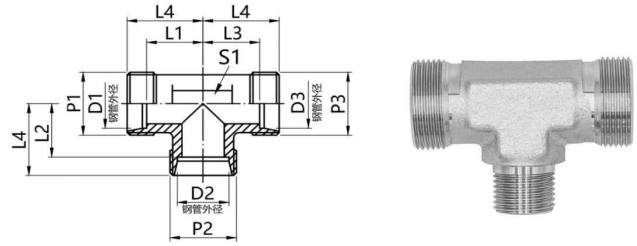

- 符合ISO8434-1, 24°卡套连接作用
- 常规供货碳钢/表面镀锌, 不锈钢
- Comply with ISO8434-1, 24° ferrule connection
- Generally supplied carbon steel/galvanized surface, stainless steel

钢管外径			尺寸				六角	螺纹			重量	型号	产品编码
D1	D2	D3	L1	L2	L3	L4	S1	P1	P2	P3	kg/100	Type	Product Code
6	8	6	14	14	14	21	12	M12x1.5	M14x1.5	M12x1.5	5.4	TR06/08/06L	BF3310608
6	10	6	15	15	15	22	14	M12x1.5	M16x1.5	M12x1.5	5.3	TR06/10/06L	BF3310610
8	6	8	14	14	14	21	12	M14x1.5	M12x1.5	M14x1.5	5.3	TR08/06/08L	BF3310806
8	10	8	15	15	15	22	14	M14x1.5	M16x1.5	M14x1.5	5.0	TR08/10/08L	BF3310810
8	12	8	17	17	17	24	17	M14x1.5	M18x1.5	M14x1.5	6.7	TR08/12/08L	BF3310812
10	6	10	15	15	15	22	14	M16x1.5	M12x1.5	M16x1.5	4.6	TR10/06/10L	BF3311006
10	8	10	15	15	15	22	14	M16x1.5	M14x1.5	M16x1.5	4.3	TR10/08/10L	BF3311008
10	10	6	15	15	15	22	14	M16x1.5	M16x1.5	M12x1.5	4.9	TR10/10/06L	BF3321006
10	15	10	21	21	21	28	19	M16x1.5	M22x1.5	M16x1.5	10.5	TR10/15/10L	BF3311015
12	6	12	17	17	17	24	17	M18x1.5	M12x1.5	M18x1.5	6.6	TR12/06/12L	BF3311206
12	8	8	17	17	17	24	17	M18x1.5	M14x1.5	M14x1.5	6.6	TR12/08/08L	BF3320812
12	8	12	17	17	17	24	17	M18x1.5	M14x1.5	M18x1.5	6.8	TR12/08/12L	BF3311208
12	10	10	17	17	17	24	17	M18x1.5	M16x1.5	M16x1.5	6.7	TR12/10/10L	BF3321012
12	10	12	17	17	17	24	17	M18x1.5	M16x1.5	M18x1.5	6.7	TR12/10/12L	BF3311210
12	12	10	17	17	17	24	17	M18x1.5	M18x1.5	M16x1.5	6.4	TR12/12/10L	BF3321210
12	15	12	21	21	21	28	19	M18x1.5	M22x1.5	M18x1.5	10.2	TR12/15/12L	BF3311215
12	18	12	24	23.5	24	31	24	M18x1.5	M26x1.5	M18x1.5	17.7	TR12/18/12L	BF3311218
15	6	15	21	21	21	28	19	M22x1.5	M12x1.5	M22x1.5	10.7	TR15/06/15L	BF3311506
15	10	15	21	21	21	28	19	M22x1.5	M16x1.5	M22x1.5	10.5	TR15/10/15L	BF3311510
15	12	12	21	21	21	28	19	M22x1.5	M18x1.5	M18x1.5	10.1	TR15/12/12L	BF3321215
15	12	15	21	21	21	28	19	M22x1.5	M18x1.5	M22x1.5	10.5	TR15/12/15L	BF3311512
15	15	12	21	21	21	28	19	M22x1.5	M22x1.5	M18x1.5	10.3	TR15/15/12L	BF3321512
18	10	10	23.5	24	24	31	24	M26x1.5	M16x1.5	M16x1.5	17.3	TR18/10/10L	BF3321018
18	10	18	23.5	24	23.5	31	24	M26x1.5	M16x1.5	M26x1.5	18.2	TR18/10/18L	BF3311810
18	12	18	23.5	24	23.5	31	24	M26x1.5	M18x1.5	M26x1.5	17.4	TR18/12/18L	BF3311812
18	15	18	23.5	24	23.5	31	24	M26x1.5	M22x1.5	M26x1.5	17.9	TR18/15/18L	BF3311815
18	18	10	23.5	23.5	24	31	24	M26x1.5	M26x1.5	M16x1.5	17.1	TR18/18/10L	BF3321810
22	10	22	27.5	28	27.5	35	27	M30x2	M16x1.5	M30x2	23.2	TR22/10/22L	BF3312210
22	12	22	27.5	28	27.5	35	27	M30x2	M18x1.5	M30x2	22.9	TR22/12/22L	BF3312212
22	15	15	27.5	28	28	35	27	M30x2	M22x1.5	M22x1.5	24.0	TR22/15/15L	BF3321522
22	15	22	27.5	28	27.5	35	27	M30x2	M22x1.5	M30x2	23.3	TR22/15/22L	BF3312215
22	18	18	27.5	27.5	27.5	35	27	M30x2	M26x1.5	M26x1.5	23.6	TR22/18/18L	BF3321822
22	18	22	27.5	27.5	27.5	35	27	M30x2	M26x1.5	M30x2	23.9	TR22/18/22L	BF3312218
22	22	18	27.5	27.5	27.5	35	27	M30x2	M30x2	M26x1.5	22.8	TR22/22/18L	BF3322218

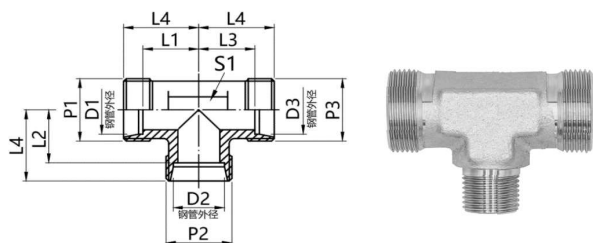

TR  
三通变径接头  
Tee reducer connector

- 符合ISO8434-1, 24°卡套连接作用
- 常规供货碳钢/表面镀锌, 不锈钢

- Comply with ISO8434-1, 24° ferrule connection
- Generally supplied carbon steel/galvanized surface, stainless steel

钢管外径			尺寸				六角	螺纹			重量	型号	产品编码
D1	D2	D3	L1	L2	L3	L4	S1	P1	P2	P3	kg/100	Type	Product Code
28	10	28	30.5	31	30.5	38	36	M36x2	M16x1.5	M36x2	41.2	TR28/10/28L	BF3312810
28	12	28	30.5	31	30.5	38	36	M36x2	M18x1.5	M36x2	40.8	TR28/12/28L	BF3312812
28	15	28	30.5	31	30.5	38	36	M36x2	M22x1.5	M36x2	42.3	TR28/15/28L	BF3312815
28	18	28	30.5	30.5	30.5	38	36	M36x2	M26x1.5	M36x2	42.1	TR28/18/28L	BF3322818
28	22	22	30.5	30.5	30.5	38	36	M36x2	M30x2	M30x2	41.2	TR28/22/22L	BF3322228
28	22	28	30.5	30.5	30.5	38	36	M36x2	M30x2	M36x2	41.5	TR28/22/28L	BF3312822
10	6	10	17.5	18	17.5	25	17	M18x1.5	M14x1.5	M18x1.5	10.3	TR10/06/10S	BF3811006
12	8	8	21.5	22	22	29	17	M20x1.5	M16x1.5	M16x1.5	10.7	TR12/08/08S	BF3820812
12	8	12	21.5	22	21.5	29	17	M20x1.5	M16x1.5	M20x1.5	10.5	TR12/08/12S	BF3811208
12	10	12	21.5	21.5	21.5	29	17	M20x1.5	M18x1.5	M20x1.5	11.4	TR12/10/12S	BF3811210
12	16	12	25.5	24.5	25.5	33	24	M20x1.5	M24x1.5	M20x1.5	19.0	TR12/16/12S	BF3811216
16	6	16	24.5	26	24.5	33	24	M24x1.5	M14x1.5	M24x1.5	17.6	TR16/06/16S	BF3811606
16	8	16	24.5	26	24.5	33	24	M24x1.5	M16x1.5	M24x1.5	20.8	TR16/08/16S	BF3811608
16	10	16	24.5	25.5	24.5	33	24	M24x1.5	M18x1.5	M24x1.5	21.0	TR16/10/16S	BF3811610
16	12	16	24.5	25.5	24.5	33	24	M24x1.5	M20x1.5	M24x1.5	38.6	TR16/12/16S	BF3811612
16	20	16	28.5	26.5	28.5	37	27	M24x1.5	M30x2	M24x1.5	29.6	TR16/20/16S	BF3811620
20	10	20	26.5	29.5	26.5	37	27	M30x2	M18x1.5	M30x2	55.3	TR20/10/20S	BF3812010
20	12	20	26.5	29.5	26.5	37	27	M30x2	M20x1.5	M30x2	30.6	TR20/12/20S	BF3812012
20	16	20	26.5	28.5	26.5	37	27	M30x2	M24x1.5	M30x2	28.5	TR20/16/20S	BF3812016
20	25	20	31.5	30	31.5	42	36	M30x2	M36x2	M30x2	54.4	TR20/25/20S	BF3812025
25	16	25	30	33.5	30	42	36	M36x2	M24x1.5	M36x2	55.6	TR25/16/25S	BF3812516
25	20	25	30	31.5	30	42	36	M36x2	M30x2	M36x2	54.4	TR25/20/25S	BF3812520
25	30	25	37	35.5	37	49	41	M36x2	M42x2	M36x2	79.1	TR25/30/25S	BF3812530