

EGE-NPT

端直通组合接头

Straight-through combination connector

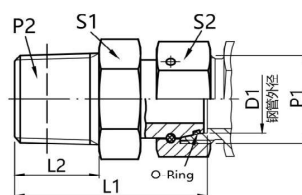

- 符合ISO8434-1, 24°卡套连接作用
- 常规供货碳钢/表面镀锌, 不锈钢
- 可提供氟橡胶密封圈
- Complies with ISO8434-1, 24° ferrule connection
- Commonly available carbon steel/galvanized surface, stainless steel
- Fluororubber sealing ring available

钢管外径		尺寸		六角		螺纹		重量	型号	产品编码
D1	L1	L2	S1	S2	P1	P2	kg/100	Type	Product Code	
6	36.5	10	11	14	M12x1.5	1/8NPT	3.7	EGE06LN1/8	BF1270602	
8	41.5	15	14	17	M14x1.5	1/4NPT	6.9	EGE08LN1/4	BF1270804	
10	40.5	15	17	19	M16x1.5	1/4NPT	5.9	EGE10LN1/4	BF1271004	
12	45.5	15	19	22	M18x1.5	3/8NPT	10.2	EGE12LN3/8	BF1271206	
15	48	20	22	27	M22x1.5	1/2NPT	15.9	EGE15LN1/2	BF1271508	
18	47.5	20	27	32	M26x1.5	1/2NPT	15.8	EGE18LN1/2	BF1271808	
22	49	20	30	36	M30x2	3/4NPT	21.6	EGE22LN3/4	BF1272212	
28	57.5	25	36	41	M36x2	1NPT	43.9	EGE28LN1	BF1272816	
35	65	26	46	50	M45x2	1 1/4NPT	50.5	EGE35LN1 1/4	BF1273520	
42	65	26	50	60	M52x2	1 1/2NPT	77.0	EGE42LN1 1/2	BF1274224	
6	41.5	15	17	17	M14x1.5	1/4NPT	6.1	EGE06SN1/4	BF1770604	
8	41.5	15	17	19	M16x1.5	1/4NPT	6.2	EGE08SN1/4	BF1770804	
10	44.5	15	19	22	M18x1.5	3/8NPT	9.0	EGE10SN3/8	BF1771006	
12	45.5	15	19	24	M20x1.5	3/8NPT	9.5	EGE12SN3/8	BF1771206	
14	53.5	20	22	27	M22x1.5	1/2NPT	17.7	EGE14SN1/2	BF1771408	
16	53.5	20	24	30	M24x1.5	1/2NPT	23.6	EGE16SN1/2	BF1771608	
20	58	20	30	36	M30x2	3/4NPT	28.3	EGE20SN3/4	BF1772012	
25	68	25	36	46	M36x2	1NPT	50.4	EGE25SN1	BF1772516	
30	73.5	26	46	50	M42x2	1 1/4NPT	65.0	EGE30SN1 1/4	BF1773020	
38	78	26	50	60	M52x2	1 1/2NPT	93.2	EGE38SN1 1/2	BF1773824	