

## 16718-R5

### 美制JIC外螺纹74°外锥面接头

American JIC external thread 74°  
external cone connector

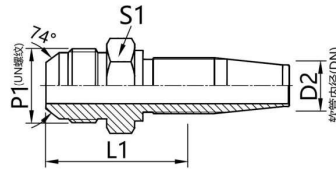

■ 常规供货碳钢/表面镀锌

■ Regular supply carbon steel/galvanized surface

软管内径 D2(DN)	软管内径 D2(in)	尺寸 L1	六角 S1	螺纹 P1	型号 Type	产品编码 Product Code
6	1/4	29	12	7/16x20	16718-04-04(R5)	HF13530404
8	5/16	31	17	9/16x18	16718-06-05(R5)	HF13530605
10	3/8	32	17	9/16x18	16718-06-06(R5)	HF13530606
10	3/8	34.7	22	3/4x16	16718-08-06(R5)	HF13530806
12	1/2	38	22	3/4x16	16718-08-08(R5)	HF13530808
16	5/8	40.5	24	7/8x14	16718-10-10(R5)	HF13531010
20	3/4	45.5	30	1 1/16x12	16718-12-12(R5)	HF13531212
25	1	44	36	1 5/16x12	16718-16-16(R5)	HF13531616
32	1 1/4	49.5	46	1 5/8x12	16718-20-20(R5)	HF13532020
40	1 1/2	52.5	50	1 7/8x12	16718-24-24(R5)	HF13532424

## 26718D-R5

### 美制JIC内螺纹74°内锥面接头

American-made JIC internal thread 74°  
internal cone connector

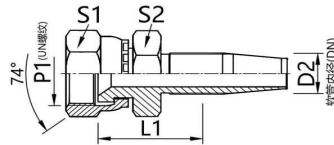

■ 常规供货碳钢/表面镀锌

■ Regular supply carbon steel/galvanized surface

软管内径 D2(DN)	软管内径 D2(in)	尺寸 L1	六角 S1	六角 S2	螺纹 P1	型号 Type	产品编码 Product Code
6	1/4	22	17	14	7/16x20	26718D-04-04(R5)	HF13540404
8	5/16	25.4	17	14	1/2x20	26718D-05-05(R5)	HF13540505
10	3/8	24.5	19	17	9/16x18	26718D-06-06(R5)	HF13540606
12	1/2	31.5	24	22	3/4x16	26718D-08-08(R5)	HF13540808
16	5/8	34	27	27	7/8x14	26718D-10-10(R5)	HF13541010
20	3/4	37	32	32	1 1/16x12	26718D-12-12(R5)	HF13541212
25	1	33.5	41	38	1 5/16x12	26718D-16-16(R5)	HF13541616
32	1 1/4	41.5	50	41	1 5/8x12	26718D-20-20(R5)	HF13542020
40	1 1/2	43	55	46	1 7/8x12	26718D-24-24(R5)	HF13542424
50	2	45.5	75	65	2 1/2x12	26718D-32-32(R5)	HF13543232