

**NB300**  
**JIC英制管衬套**  
 JIC Inch Pipe Bushings

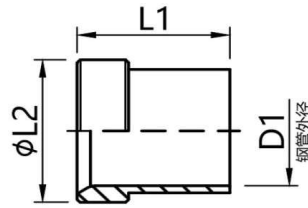

- 常规供货碳钢/表面镀锌, 不锈钢
- SAE J514/ISO 8434-2标准接头

- Commonly supplied carbon steel/galvanized surface, stainless steel
- SAE J514/ISO 8434-2 standard connector

钢管外径 D1(in)	尺寸		型号 Type	产品编码 Product Code
	L1	L2		
1/4	10.4	9.73	NB300-04	JF0010404
5/16	11.2	11.3	NB300-05	JF0010505
3/8	12.7	12.75	NB300-06	JF0010606
1/2	14.2	17.32	NB300-08	JF0010808
5/8	16.8	20.24	NB300-10	JF0011010
3/4	17.3	24.69	NB300-12	JF0011212
7/8	19.3	27.86	NB300-14	JF0011414
1	19.8	31.04	NB300-16	JF0011616
1 1/4	23.1	38.96	NB300-20	JF0012020
1 1/2	28.4	45.31	NB300-24	JF0012424
2	30.2	61.19	NB300-32	JF0013232

**NB500**  
**JIC公制管衬套**  
 JIC Inch Pipe Bushings

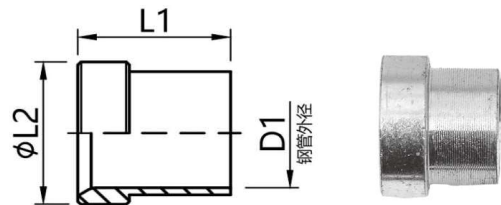

- 常规供货碳钢/表面镀锌, 不锈钢
- SAE J514/ISO 8434-2标准接头

- Commonly supplied carbon steel/galvanized surface, stainless steel
- SAE J514/ISO 8434-2 standard connector

钢管外径 D1(in)	尺寸		型号 Type	产品编码 Product Code
	L1	L2		
6	10.4	9.7	NB500-06	JF0000606
8	11.2	11.3	NB500-08	JF0000808
10	12.7	12.75	NB500-10	JF0001010
12	14.2	17.3	NB500-12	JF0001212
14	16.8	20.2	NB500-14	JF0001414
15	16.8	20.2	NB500-15	JF0001515
16	16.8	20.2	NB500-16	JF0001616
18	17.3	24.7	NB500-18	JF0001818
20	19.3	27.8	NB500-20	JF0002020
22	19.3	27.8	NB500-22	JF0002222
25	19.8	31	NB500-25	JF0002525
28	23.1	38.9	NB500-28	JF0002828
30	23.1	38.9	NB500-30	JF0003030
32	23.1	38.9	NB500-32	JF0003232
35	28.4	45.3	NB500-35	JF0003535
38	28.4	45.3	NB500-38	JF0003838
50	30.2	61.2	NB500-50	JF0005050