

**SB**  
**蓄能器**  
Accumulators

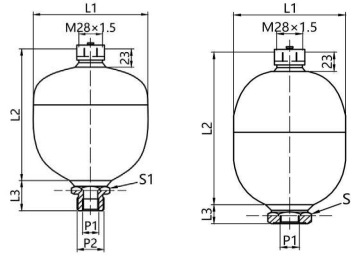

- 适用温度: -15°C~+80°C
- 常规材质: 碳钢
- 上下半球体焊接密封
- 内有NBR材质

- Applicable temperature: -15°C~+80°C
- Conventional material: carbon steel
- Upper and lower hemispheres welded and sealed
- NBR material inside

容量		尺寸			六角	螺纹		重量	流量	预充压力	最大压力	图号	型号	产品编码
L	L1	L2	L3	S1	P1	P2	kg	L/m	Mpa	Mpa	NO	Type	Product Code	
0.5	102	130	37	41	G1/2	M33x1.5	1.3	95	16	128	1	SB160-0.5E1/112U-160AB	HV30100	
0.5	105	133	37	41	G1/2	M33x1.5	1.7	95	21	168	1	SB210-0.5E1/112U-210AB	HV30101	
0.6	115	151	37	41	G1/2	M33x1.5	3.3	95	33	264	1	SB330-0.6E1/112U-330AB	HV30102	
0.7	106	151	37	41	G1/2	M33x1.5	1.8	95	10	80	1	SB100-0.7E1/112U-100AB	HV30103	
0.75	116	142	37	41	G1/2	M33x1.5	1.8	95	14	112	1	SB140-0.75E1/112U-140AB	HV30104	
0.75	121	147	37	41	G1/2	M33x1.5	2.8	95	21	168	1	SB210-0.75E1/112U-210AB	HV30105	
0.75	126	152	37	41	G1/2	M33x1.5	3.6	95	25	200	1	SB250-0.75E1/112U-250AB	HV30106	
1	136	159	37	41	G1/2	M33x1.5	3.6	95	20	160	1	SB200-1E1/112U-200AB	HV30107	
1.4	145	173	37	41	G1/2	M33x1.5	3.9	95	14	112	1	SB140-1.4E1/112U-140AB	HV30108	
1.4	150	178	37	41	G1/2	M33x1.5	5.4	95	21	168	1	SB210-1.4E1/112U-210AB	HV30109	
1.4	153	185	37	41	G1/2	M33x1.5	5.9	95	25	200	1	SB250-1.4E1/112U-250AB	HV30110	
2	160	190	33	46	G3/4	M45x1.5	4	150	10	80	1	SB100-2E1/112U-100AB	HV30111	
2	167	198	33	46	G3/4	M45x1.5	6.6	150	21	168	1	SB210-2E1/112U-210AB	HV30112	
1	126	192	21	41	G1/2		4.4	95	25	100	2	SB250-1E1/112U-250AK	HV30201	
2	153	232	28	46	G3/4		7.4	150	25	100	2	SB250-2E1/112U-250AK	HV30202	
2.8	167	250	28	46	G3/4		8.2	150	21	84	2	SB210-2.8E1/112U-210AK	HV30203	
2.8	170	250	28	46	G3/4		9.5	150	25	100	2	SB250-2.8E1/112U-250AK	HV30204	
3.5	170	306	28	46	G3/4		11.2	150	25	100	2	SB250-3.5E1/112U-250AK	HV30205	

注:需要了解更多数据和型号,请联系我们。  
Note: For more data and models, please contact us